

LED Lighted Outdoor Patio Umbrella

1. Is the included rechargeable battery in the bottom of the solar panel?
2. If yes, is it installed properly with the + end of the battery making firm contact with the metal plate and – end of the battery making contact with the metal spring? (Check to see if there is a tab or film covering either end of the battery, if yes remove the film)
3. Is the wire and socket under the solar panel plugged into the top of the umbrella canopy?

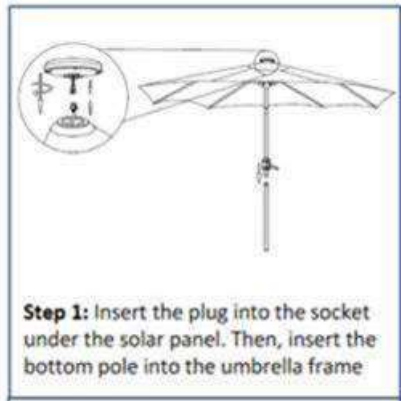

4. Is the film removed from the top of the solar panel?
5. Has the solar panel been indirect sunlight for 8 hours?
6. Is the switch located at the end of one of the canopy ribs, pushed to ON?

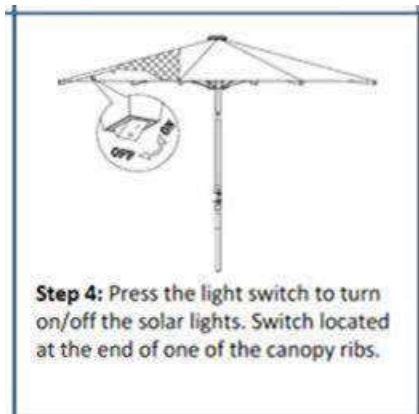

7. Is the solar panel exposed to other light sources at night? The light may affect the photosensor and cause the lamp to turn off.